

Cim 903A

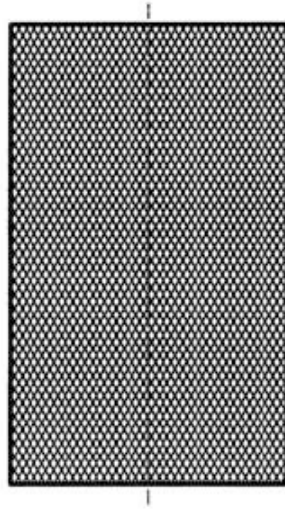

Den er produsert i AISI 304 rustfritt stål.

TEKNISK TEGNING

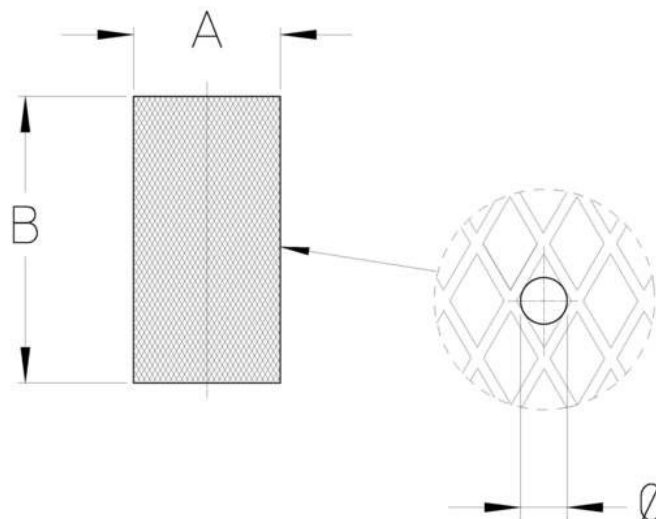

DN	3/8"	1/2"	3/4"	1"	1"1/4	1"1/2	2"
Grms.	1,5	1,5	2,6	3,7	6,5	7,4	18,5
A	16,3	16,3	20,5	26,5	34,8	40,3	54,4
B	22	22,5	40	44	56	60	72
Φ micron	250	250	250	250	250	250	250